

DOWEL PINS

RoHS

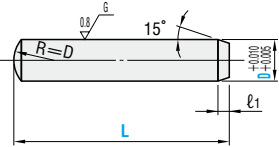

MS (Straight type)



M SUJ2
H 58HRC~

MSV (High precision type)

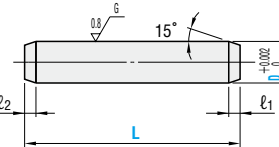

M SUJ2
H 58HRC~

MSTP (Tapped precision type)

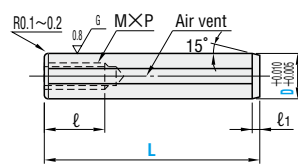

* If L dimension is 10 with D5-6, the pilot hole for the tap may go all the way through.

M SUJ2
H 58HRC~

MST (Tapped p6 type)

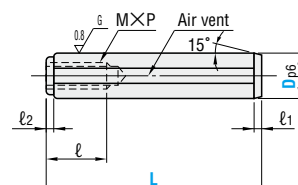

* If L dimension is 10 with D5-6, the pilot hole for the tap may go all the way through.

(Identifying groove)

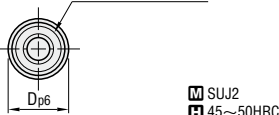

M SUJ2
H 45~50HRC

⊕ ℓ₁·ℓ₂ dimensions are values for reference only. The actual values at the outer diameter grinding process may be larger than the catalog values.

ℓ ₁	ℓ ₂	Catalog No.		L	Base unit price 1~99 pcs.	Volume discount unit price 100~499 500~1999 2000~4000	
		Type	D				
0.4	0.6	1	6 8 10				
			1.5	6 8 10			
1.0	1.0	2	6 8 10 15				
			2.5	6 8 10 15 20			
		3	6 8	10 15 20 25 30			
			4	6 8	10 15 20 25 30 35 40		
1.5	1.5	4	8	10 15 20 25 30 35 40 45 50			
			5	8	10 15 20 25 30 35 40 45 50		
2.0	2.0	6	8 10	15 20 25 30 35 40 45 50 55 60			
			8	10 15 20 25 30 35 40 45 50 55 60 65 70 80			
2.5	2.5	10	15 20 25 30 35	40 45 50 55 60 65 70 80			
			12	20 25 30 35 40 45 50 55 60 70 80			
3.0	3.0	13	30	40 50 60 70 80			

Quotation

ℓ ₁	ℓ ₂	Catalog No.		L	Base unit price 1~99 pcs.	Volume discount unit price 100~499 500~1999 2000~4000
		Type	D			
1.0	0.2	2	6 8 10			
			3	8 10 15 20 25 30		
1.5	0.5	4	10 15 20 25 30			
			5	10 15 20 25 30		
2.0	2.0	6	10 15 20 25 30			
			8	10 15 20 25 30 30 40		
2.5	2.5	10	20	30 40 50 60		

Quotation

⊕ The high-precision dowel pins are measured in a constant temperature chamber.

ℓ ₁	ℓ ₂	M P	ℓ	D	Catalog No.		L	Base unit price 1~99 pcs.	Volume discount unit price 100~499 500~1999 2000~4000
					Type	D			
1.5	0.3	3	*6	+0.010 +0.005	MSTP	5	10 15 20 25 30		
						6	10 15 25 30 35 40 50		
2.0	0.5	5	*8	+0.010 +0.005	MSTP	8	15 20 25 30 35 40 45 50 60 70 80		
						10	15 20 25 30 35 40 45 50 60 70 80		
2.5	1.0	6	10	+0.010 +0.005	MSTP	12	20 30 40 50 60 70 80		
						13	40 50 60 70 80		
3.0	1.25	8	15	+0.010 +0.005	MSTP	16	40 50 60 70 80		

⊕ * If D=5, then ℓ=6 is a value for reference only. ⊕ * Only if D=6 and L=10, then ℓ=6.

ℓ ₁	ℓ ₂	M P	ℓ	D _{p6}	Catalog No.		L	Base unit price 1~99 pcs.	Volume discount unit price 100~499 500~1999 2000~4000
					Type	D			
1.5	0.5	3	*6	+0.020 +0.012	MST	5	10 15 20 25 30		
						6	10 15 25 30 35 40 50		
2.0	0.7	5	*8	+0.024 +0.015	MST	8	15 20 25 30 35 40 45 50 60 70 80		
						10	15 20 25 30 35 40 45 50 60 70 80		
2.5	1.0	6	10	+0.029 +0.018	MST	12	20 30 40 50 60 70 80		
						13	40 50 60 70 80		
3.0	1.25	8	15	+0.029 +0.022	MST	16	40 50 60 70 80		
						20	50 60 70 80		

⊕ * If D=5, then ℓ=6 is a value for reference only. ⊕ * Only if D=6 and L=10, then ℓ=6.

⊕ ℓ₁·ℓ₂ dimensions are values for reference only. The actual values at the outer diameter grinding process may be larger than the catalog values.

ℓ ₁	ℓ ₂	M P	ℓ	D _{m6}	Catalog No.		L	Base unit price 1~299 pcs.	Volume discount unit price 300~499 500~1999 2000~4000
					Type	D			
1.5	0.3	3	*6	+0.012 +0.004	MSTM	5	10 15 20 25 30		
						6	10 15 20 25 30 35 40 50		
2.0	0.5	5	*8	+0.015 +0.006	MSTM	8	15 20 25 30 35 40 45 50 60 70 80		
						10	15 20 25 30 35 40 45 50 60 70 80		
2.5	1.0	6	10	+0.018 +0.007	MSTM	12	20 30 40 50 60 70 80		
						13	40 50 60 70 80		
3.0	1.5	8	15	+0.021 +0.008	MSTM	16	40 50 60 70 80		
						20	50 60 70 80		

Quotation

⊕ * If D=5, then ℓ=6 is a value for reference only. * Only if D=6 and L=10, then ℓ=6.

MXP	ℓ	Catalog No.	D	L	Base unit price 1~299 pcs.	Volume discount unit price 300~499 500~1999 2000~4000
5×0.8	9	8	30	40		
6×1.0	10	10	40	50		
8×1.25	14	13	50	60		
10×1.5	16	16	60	70		

Quotation

ℓ ₁	D _{h7}	Catalog No.	D	L	Base unit price 1~299 pcs.	Volume discount unit price 300~499 500~1999 2000~4000
1.0	0	MSSH	2	6 8 10 15		
			3	8 10 15 20		
1.5	0	MSSH	4	10 15 20		

Quotation

MSTM (Tapped m6 type)

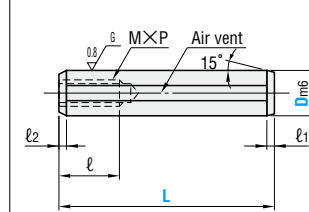

* If L dimension is 10 with D5-6, the pilot hole for the tap may go all the way through.



M SUJ2
H 45~50HRC

MTT (Tapped and tapered type)

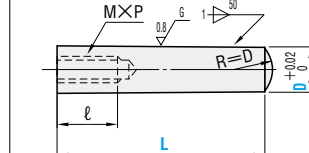

M SUJ2
H 45~50HRC

MSSH (Straight h7 type)

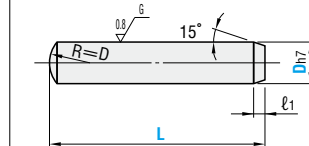

M SUJ2
H 45~50HRC

MSTH (Tapped h7 type)

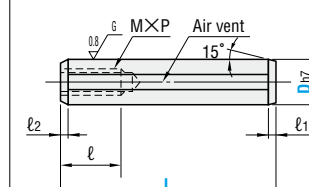

M SUJ2
H 45~50HRC

* If L dimension is 10 with D5-6, the pilot hole for the tap may go all the way through.

⊕ * If D=5, then ℓ=6 is a value for reference only. * Only if D=6 and L=10, then ℓ=6. ⊕ MSTH economy packs P.803

Order Catalog No. — L
MS2 — 10

Days to Ship Quotation

