

Precision Ball Screws Standard Nut - Shaft Dia. 25; Lead 5, 10, 25

Accuracy Grade C5

Points of comparison
between similar products

C-VALUE parts' load rating, axial clearance and nut dimensions are different from similar parts. (For details, see P.677~ P.679)
When considering C-VALUE parts, choose by comparing the specifications against similar parts.

Similar parts listed page P.749, 750



Nut Type	Type	Accuracy Grade	Shaft Dia.	Lead	Screw Shaft		Nut	
					Material	Hardness	Material	Hardness
Standard Nut	C-BSS	C5	25	5, 10, 25	S55C	Induction Hardened 58~62HRC	SCM415	Carburized 58~62HRC

C-BSS2505

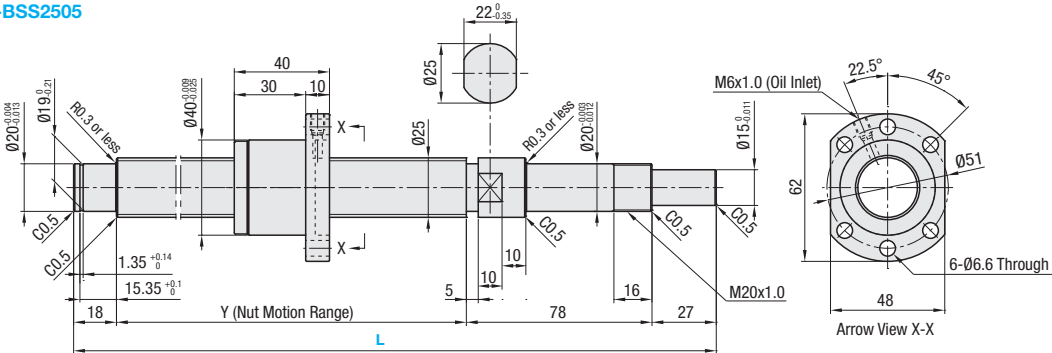

C-BSS2510

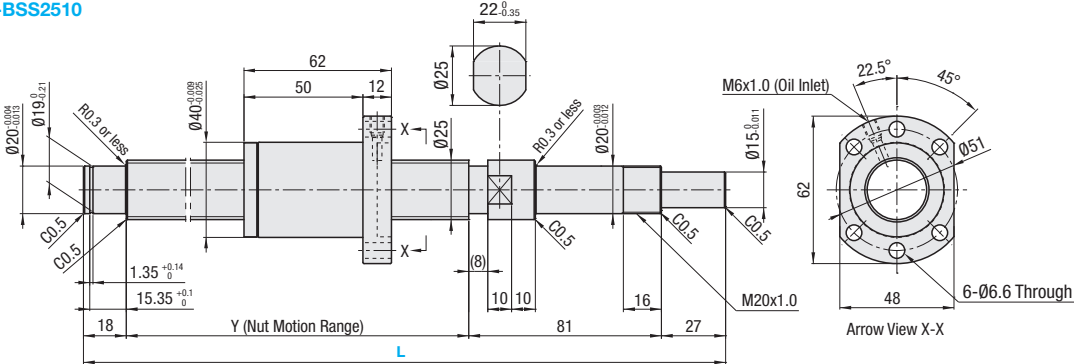

C-BSS2525

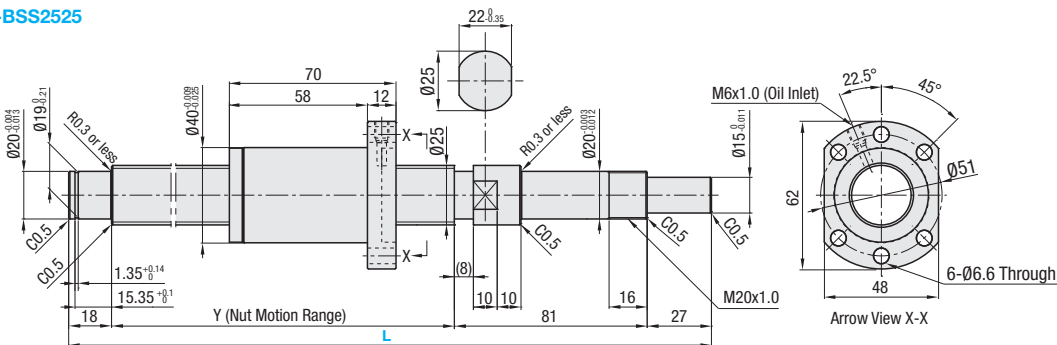

Nut Type	Accuracy Grade	Part Number			1mm Increment L	Y	Ball Dia.	Ball Center Dia.	Screw Root Dia.	Number of Circuits	Basic Load Rating		Axial Play	Preload Torque N·cm	Twisting Direction
		Type	Screw Shaft O.D.	Lead							C (Dynamic) kN	Co (Static) kN			
Standard Nut	C5	C-BSS	25	05	300~995	L-123	3.175	26.08	(22.905)	3.8 turns, 1 row	7.8	18.2	0.015 or Less	6.0 or Less	Right
				10	300~1500	L-126					11.3	23.4			
				25							1.8 turns, 1 row	7.3			

kgf=Nx0.101972

Nut Type	Accuracy Grade	Part Number	Unit Price 1 ~ 4 pc(s).						
			L300~400	L401~595	L596~600	L601~800	L801~1000	L1001~1200	L1201~1500
Standard Nut	C5	C-BSS2505						-	-
		C-BSS2510							
		C-BSS2525							



Ordering Example

Part Number - L
C-BSS2510 - 720

Notes

- Filled with lithium soap based grease (Alvania Grease S2 made by Showa Shell Sekiyu K.K.).
- For accuracy of Ball Screws, see P.2223 and P.2224.
- For details of Support Units, see P.753 ~ P.778.
- Cautions: Do not let the nuts overrun or remove the nuts from the screw shafts. It may cause the balls to fall out or damage the ball recirculation parts.
- Do not tilt the ball screw assembly since the nut may spin off from the shaft due to its own weight.
- Use one of the support unit accessory collars on the fastening nut side.

<Do not let a nut overrun>

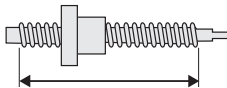

<Do not take a nut off>

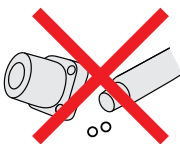

Alterations

Part Number - L - (FC, MC...etc.)
C-BSS2505 - 789 - RLC

Alterations	Code	Spec.
No Machining on Support Side Shaft End	NC	No machining added on the support side shaft end. Ordering Code NC
Ball Nut Orientation Reversed (Support Side) - (Fixed Side) Std. Revised	RLC	Changes the nut direction. Ordering Code RLC
No Retaining Ring Groove on Support Side Shaft End	RNC	Retaining ring groove is not machined on the support side shaft end. Ordering Code RNC Combination with FC is not available.
Change Support Side Shaft End Machining	GC	Changes the machining on the support side. Q is selectable from 10, 12, 15, 20. G=1mm Increment Ordering Code GC-Q10-G20 5≤G≤Qx3 Y dimension is shortened.
Change Support Side Shaft End Length	FC	Changes the length of the support side shaft end. FC=1mm Increment Ordering Code FC20 19≤FC≤60 Y dimension is shortened.

Alterations	Code	Spec.
Tapped Hole on Support Side Shaft End	MC	Adds a tapped hole on the support side shaft end. MC=1mm Increment Ordering Code MC40 M Mx1.25 L 20 28≤MC≤60 Y dimension is shortened.
Keyway on Fixed Side Shaft End Detailed Keyway Dimensions P.684	KC	Adds a keyway on the fixed side shaft end. KC=1mm Increment Ordering Code KC20 5≤KC≤26
Keyway on Fixed Side Shaft End	KLC	Adds a keyway at a customer specified area on the fixed side shaft end. (Keyway dim. is same as KC.) K, S=1mm Increment Ordering Code KLC-K20-S3 6≤K+S≤26
Flat Machined on Fixed Side Shaft End	SC	Adds a flat on the fixed side shaft end. SC=1mm Increment Ordering Code SC20 5≤SC≤26
2 Flats Machined on Fixed Side Shaft End	SWC SGC	Adds two flats on the fixed side shaft end. SWC: 90° Position SGC: 120° Position 1mm Increment Ordering Code SWC20 5≤SWC, SGC≤26

Peripherals: Combination of the following parts is available.

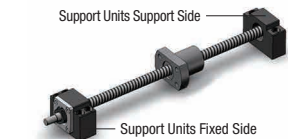
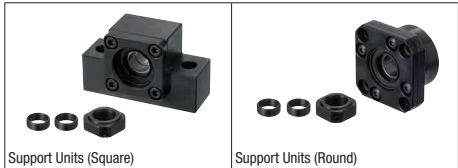

Combination with Support Units

Ball Screw Part Number			Recommended Support Unit			
Type	Screw Shaft O.D.	Lead	Part Number Type No.	Shape	Fixed Side	Support Side
C-BSS	25	05 10 25	C-BRW	Round	○	○
			C-BUR		○	○
			C-BSW	Square	○	○
			C-BUN		○	○

Other than the part numbers shown above, a wide variety of Support Units are also available. (P.753~P.778)